

# This is your ErgoOne® FAST Quickstart Manual.

## Removing the discharge protector

Prior to first usage please proceed as follows:

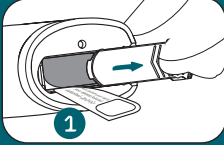

Slide the battery compartment lid open.

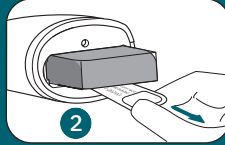

Remove the battery and discharge protection.

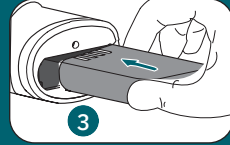

Install the battery and close the battery compartment lid.

## Battery status display

Ready for operation:

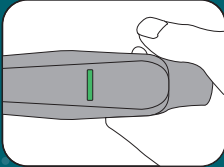

**Solid green light:**  
The rechargeable battery is fully charged.

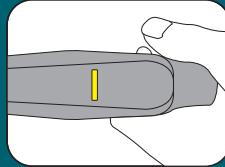

**Solid yellow light:**  
The rechargeable battery is half-charged.

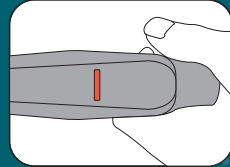

**Solid red light:**  
The rechargeable battery is almost empty.

## Empty battery

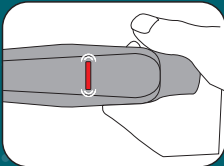

**Flashing red light:**  
The rechargeable battery needs to be charged.

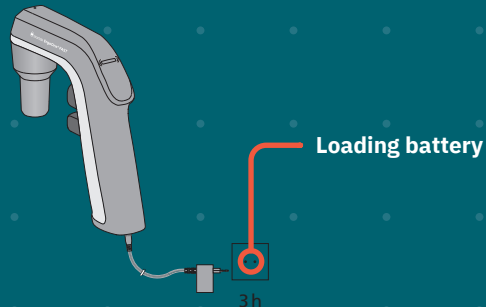

Passionate for science.



# This is your ErgoOne® FAST Quickstart Manual.

## Battery status display

Charge battery:

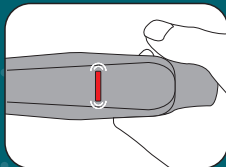

### Flashing red light:

The rechargeable battery is < 5% charged.

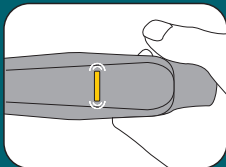

### Flashing yellow light:

The rechargeable battery is 5 - 60% charged.

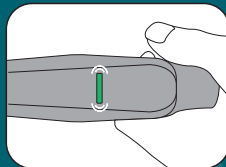

### Flashing green light:

The rechargeable battery is 60 - 99% charged.

## Speed control

The liquid aspiration speed is regulated continuously by controlling the pressure on the control buttons, i.e. how far in the button is pressed.

### Slow aspiration

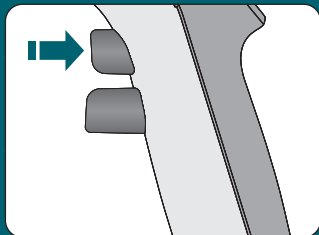

To slowly aspirate or dispense liquid, press the corresponding control button lightly.

### Quickly aspirating

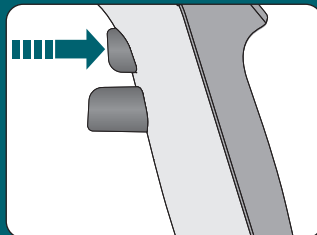

To quickly aspirate or dispense liquid, press the corresponding control button firmly.

QSM/EOE-INT-03-2021